

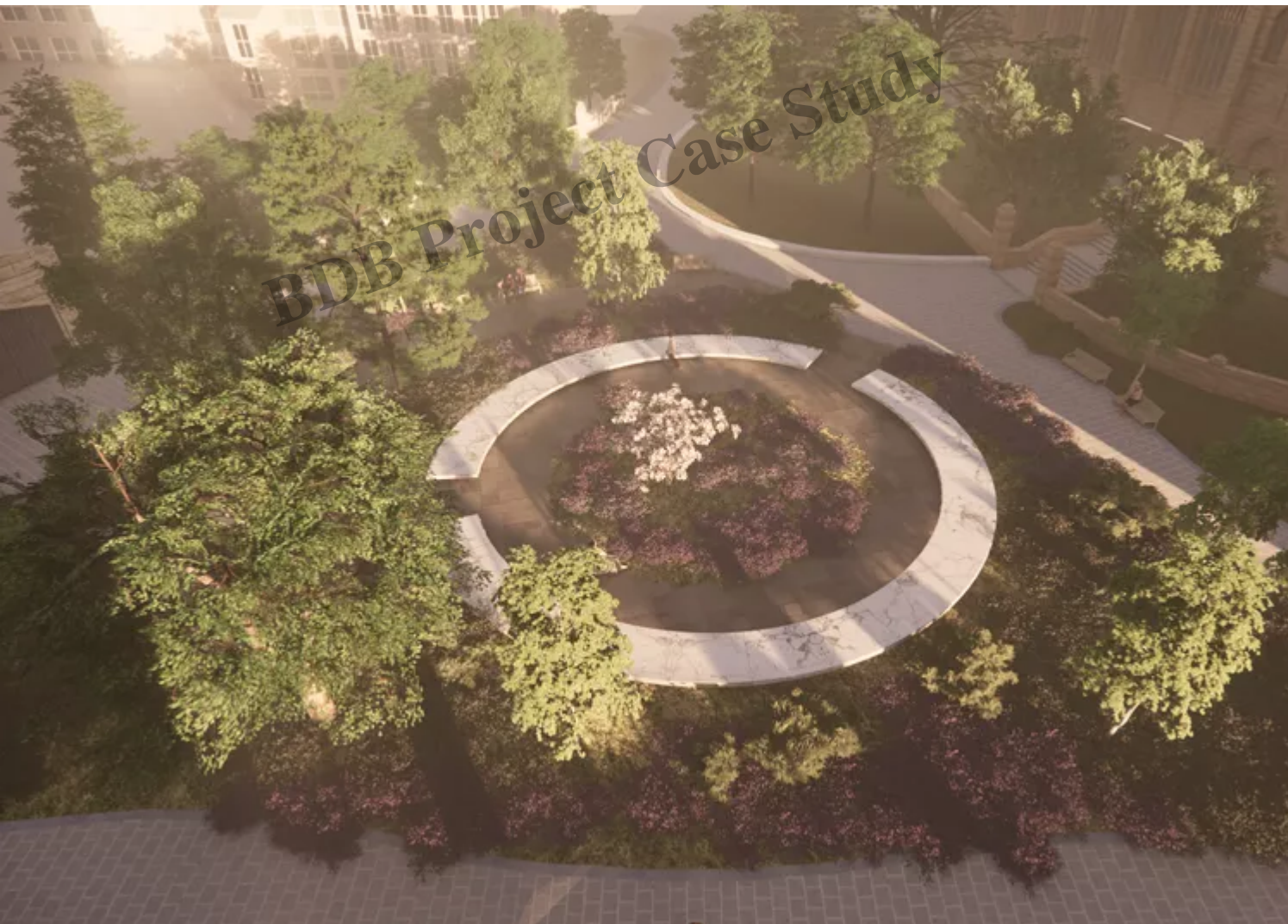

Glade of Light

Description



Commercial

Galliford Try

SERVICES

Bulk Earthworks
Disposals
Drainage
Kerbs
Footpath
Concrete

LOCATION

Manchester

CONTRACT DURATION

8 months

VALUE

600k

BDB Project Case Study

[DOWNLOAD THIS PROJECT CASE STUDY](#)

Glade of Light

Project Summary

The Glade of Light is the memorial garden for the victims of the Manchester Arena bombing. BDB undertook the groundworks on the scheme including site clearance, drainage, ductwork, hard & soft landscaping and construction of reinforced concrete structures.

SCOPE OF WORK

N/A

THE CHALLENGES

N/A

[DOWNLOAD THIS PROJECT CASE STUDY](#)

PROJECT GALLERY



BDB Project Case Study

supply chain partners



NEED OUR HELP WITH YOUR PROJECT?

From early contractor involvement to completion on site we will work alongside our customers collaboratively, openly and transparently. We provide an approachable and personal service at all levels. We aim to be the partner of choice for both clients and our supply chain.

 [+44 \(0\) 161 797 4444](tel:+441617974444)

 info@bdbspecialprojects.co.uk

Date Created

2024/08/16

Author

seeksocial

BDB Project Case Study